

GENERAL POLICY AND PROCEDURE

DEPARTMENT OF PUBLIC SERVICE
TRANSPORTATION DIVISION
CITY OF COLUMBUS, OHIO

SUBJECT: Signage requirements for private streets

EFFECTIVE DATE: March 1, 2004

PAGES: 1 OF: 2 **BY:** ASB

POLICY:

The purpose of this document is to set forth the policies and procedures regarding signage for private streets within the City of Columbus.

The following signage standards must be followed when required under the statutes of Title 31: Planning and Platting Code and/or Title 33: Zoning Code.

PROCEDURE:

1. Parking restrictions

General Requirements:

- All signs must be made with Type VIII or IX reflective sheeting.
- All signs must conform to the attached City of Columbus sign designs.
- Outside borders of a different color or signs mounted in a routed wood border are acceptable.
- Signs should be mounted on U-channel drive posts or utility poles, but may be mounted on other supports, such as wood posts, as long as the supports conform to the breakaway standards set forth in the current version of the Ohio Manual of Uniform Traffic Control Devices (OMUTCD).

Signage requirements for streets:

- The parking restriction signs for streets shall be mounted at 45° to on-coming traffic.
- Spacing requirements are as follows (see attached typical drawings also):
 - On a block face 200' long or less, install one sign near the middle of the block.
 - On a block face between 200' and 400' long, 2 signs per block are required. Each sign must be within 100' of the nearest intersection.
 - On block faces longer than 400', 1 sign, at maximum of 100' from the nearest intersection and additional signs as needed so there is approximately 200' between signs.

Signage requirements for alleys/lanes:

- Signs shall be posted at each entrance to the development stating "Alley Parking Prohibited, Violators Will Be Towed". The minimum size of these signs is 18" x 24". Larger signs may be posted at the sole discretion of the Homeowners Association (HOA). See attached typical.
- The signs are to be mounted 90° to on-coming traffic.
- Signs may be posted at the beginning of each alley at the request of the City and/or the HOA. The minimum size of these signs is 12" x 18". Larger signs may be posted at the sole discretion of the HOA. See attached typical.

2. Street name signs

- Signs shall be installed wherever a street intersects with another street with a different name.
- In situations where there is one street name for a non-traditional street system, address lead-in signs should be installed.
- All signs must be made with Type VIII or IX reflective sheeting.
- See attached City of Columbus sign material and placement standards. Different sign supports and attachment hardware can be used; the attached standards are only for guidance. The City also attaches signs to utility poles whenever possible.
- Minimum letter heights and sign sizes must be maintained. The City uses Highway Gothic font for letters. Other fonts may be used, but care should be taken to ensure readability.
- Sign colors:
 - At the intersection of two public streets, the street name signs are to be the standard white letters on a green background.
 - At the intersection of two private streets, the street name signs still must have white letters, but the background color can be any except green.
 - At the intersection of a private street and a public street, the street name sign for the public street must conform to the colors for a public street and the street name sign for the private street must conform to the colors for a private street.

APPROVED BY:

PAMELA A. CLAWSON, P.E., ADMINISTRATOR

3-5-04
DATE

COLUMBUS SIGN DESIGN

ORDER NO. **CR-430**
 APPROVED _____

DEPARTMENT OF PUBLIC SERVICE
 TRANSPORTATION DIVISION
 CITY OF COLUMBUS, OHIO

RES. _____ SITE. _____

SERIES **COLS. REG** COLOR **RED/WHITE** BY **KEITH WELLS** DATE **1-15-04**

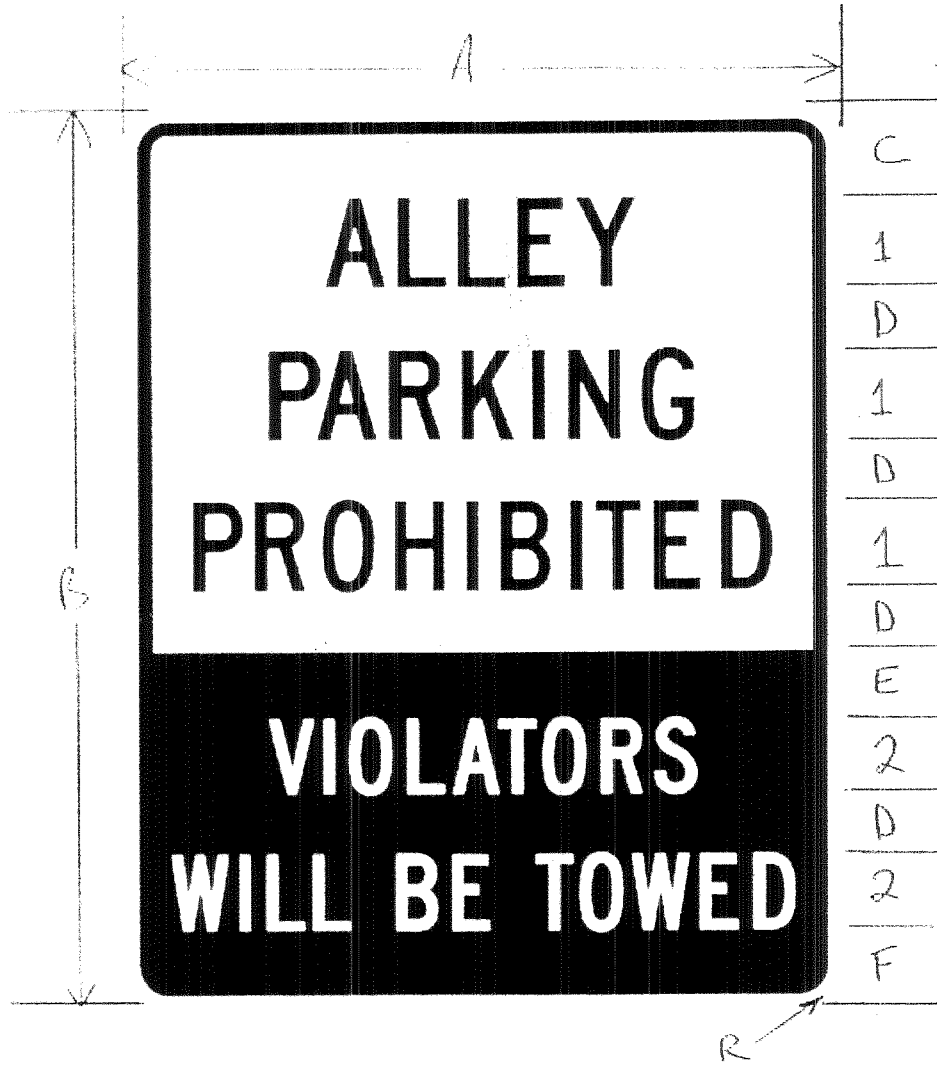

A	B	LETTER SIZES					C	D	E	F	G	H	J	K	L
		1	2	3	4	5									
24"	30"	3" C	2.5" C				3"	2"	2.25"	2.25"					
18"	24"	2.375" C	2" C				2.375"	1.625"	1.75"	2.25"					
12"	18"	1.75" C	1.375" C				1.875"	1.25"	1.375"	1.75"					
											R			BORDER	MARGIN
										1.5"				.5"	.5"
										1.5"				.375"	.375"
										1.5"				.375"	.375"

STREET OR ALLEY

* MORE SIGNS AT CLOSER SPACING, MAY BE INSTALLED IF CITY OF COLUMBUS OR HOA DETERMINE THERE IS A NEED FOR ADDITIONAL SIGNING
PARKING RESTRICTIONS MUST BE INSTALLED ON SAME SIDE AS HYDRANT

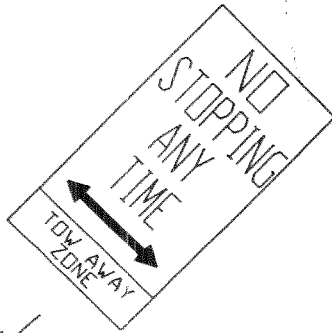

LEGEND:

- ⊙ HYDRANT
- ∟ U-CHANNEL DRIVE POST

CP-116.16 (L)(R)(D)
12" x 24"

⊙

∟

⊙

STREET (22' WIDE TYP.)

200' OR LESS

MAXIMUM 100' FROM BEGINNING OF BLOCK

STREET OR ALLEY

CALC. BY:
MAD

CHECKED BY:
ASB

SIGNAGE STANDARDS FOR PRIVATE STREETS

Ⓐ

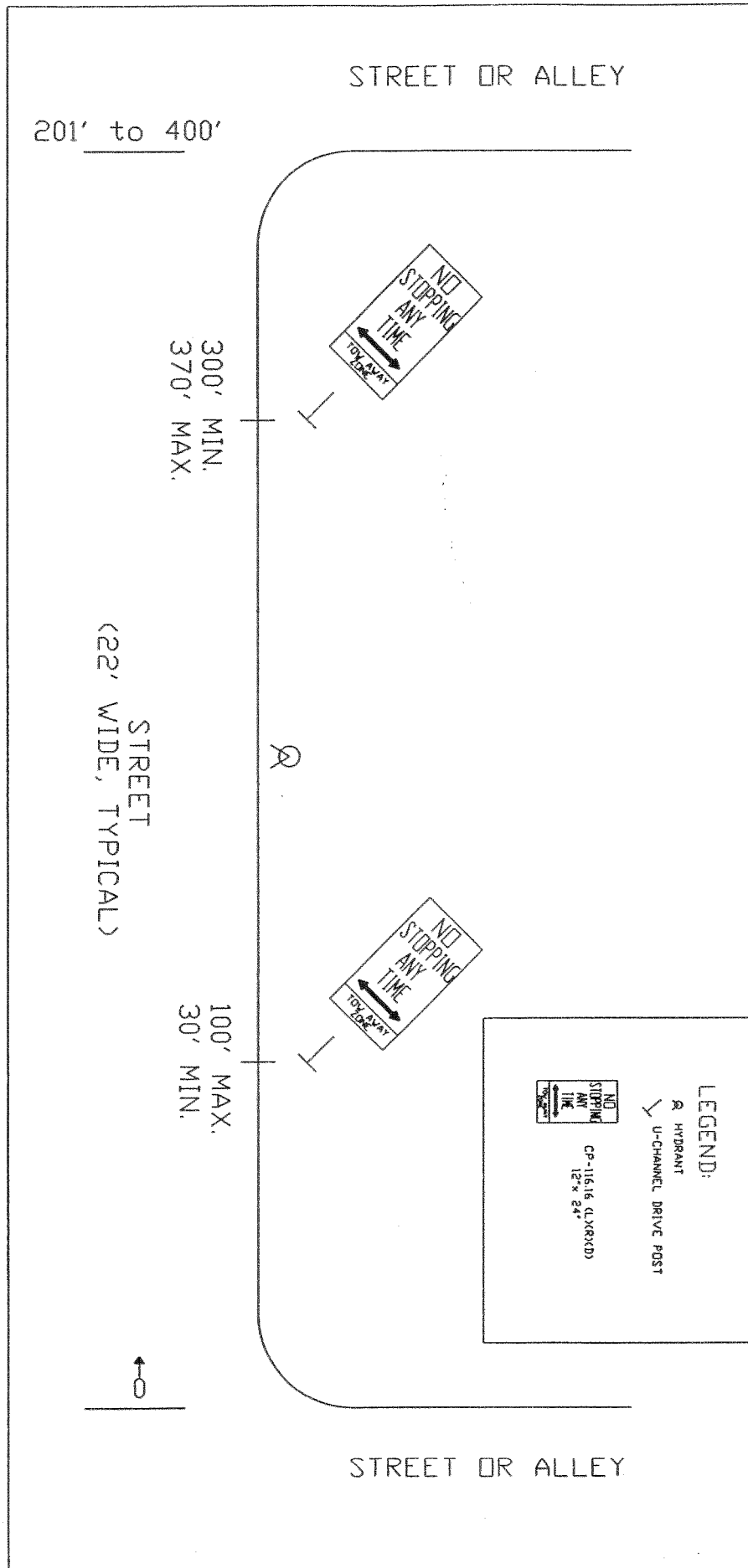

(B)

SIGNAGE STANDARDS FOR PRIVATE STREETS

CALC. BY:
MAD
CHECKED BY:
ASB

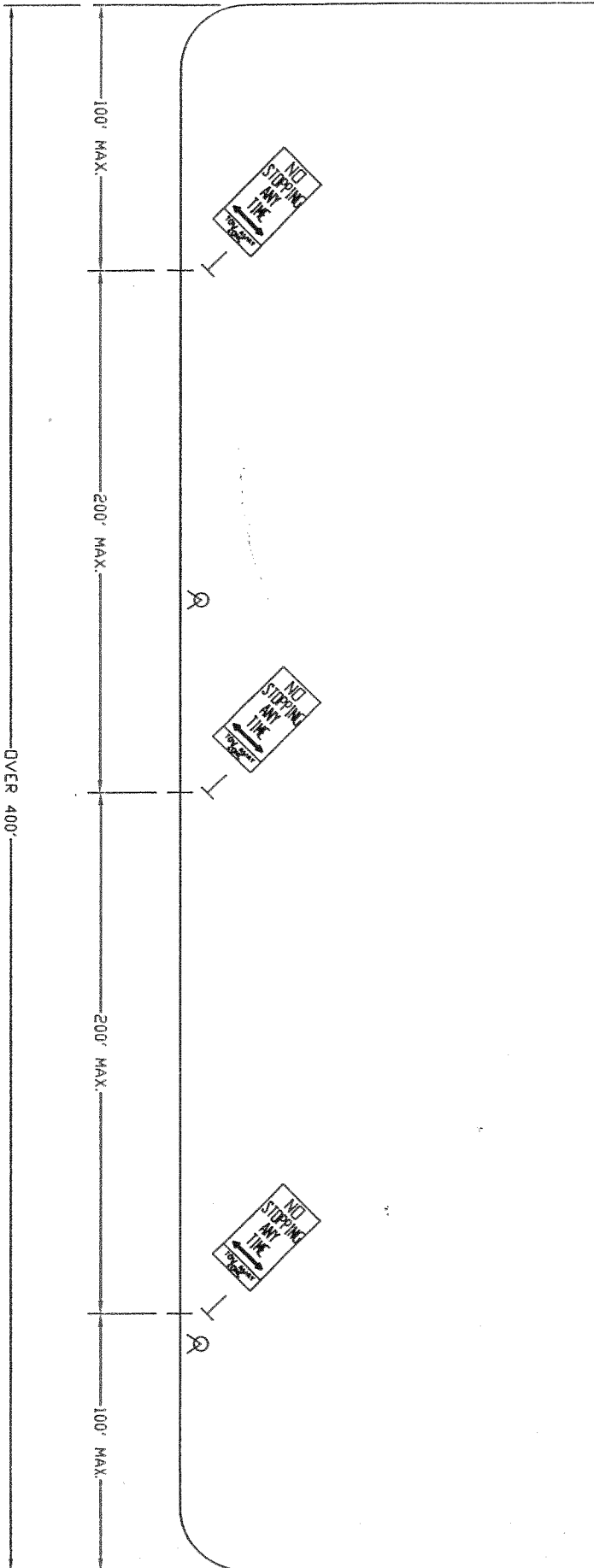

LEGEND:

- ⊕ HYDRANT
- ↙ U-CHANNEL DRIVE POST

CP-11616 (LXBXD)
12" x 24"

STREET
(22' WIDE, TYPICAL)

OVER 400'



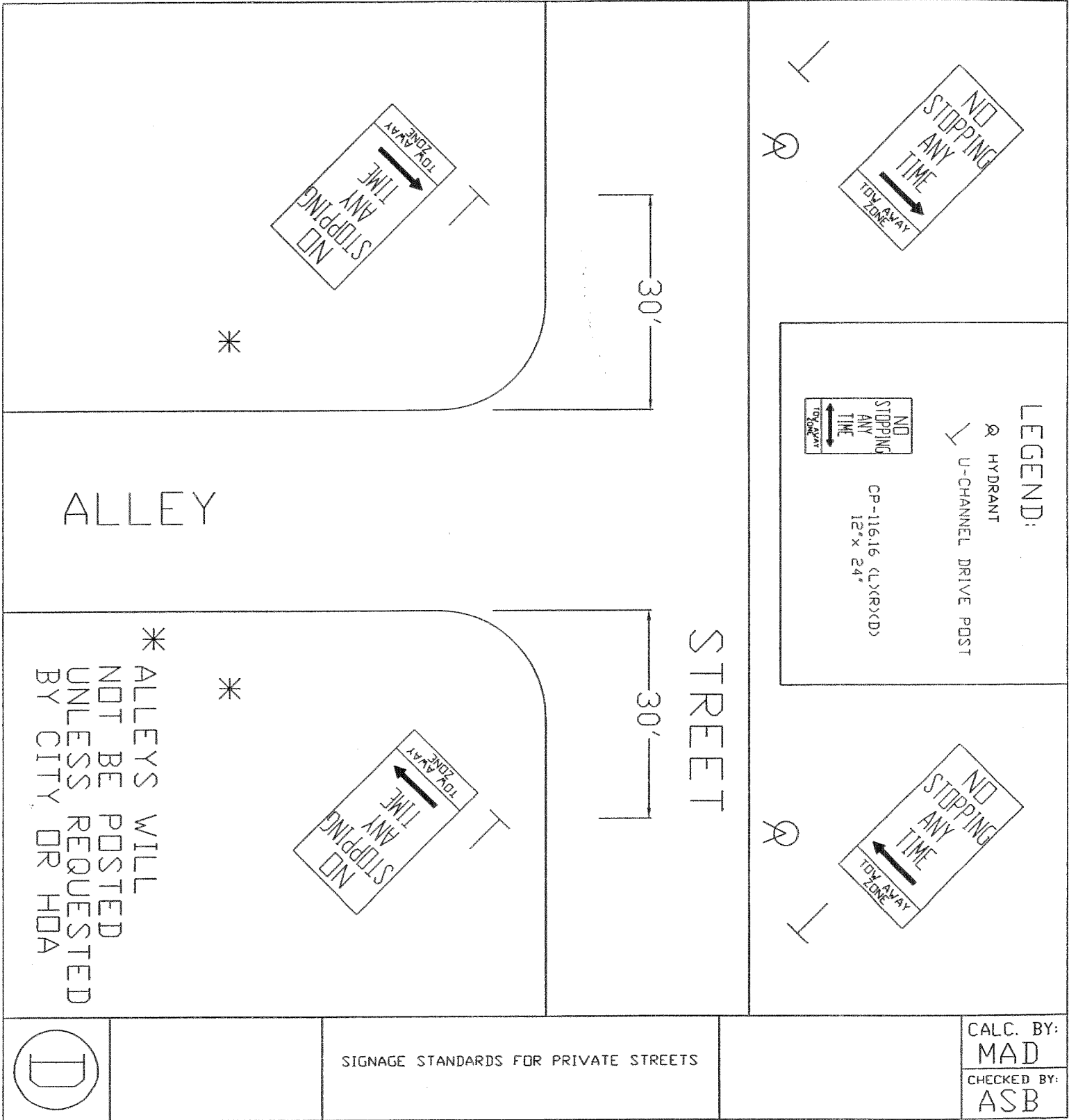

* ALLEYS WILL NOT BE POSTED
UNLESS REQUESTED BY CITY OR HOA

LEGEND:

⊗ HYDRANT

∟ U-CHANNEL DRIVE POST

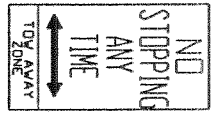

CP-116.16 (L)(R)(D)
12' x 24'

*

ALLEY

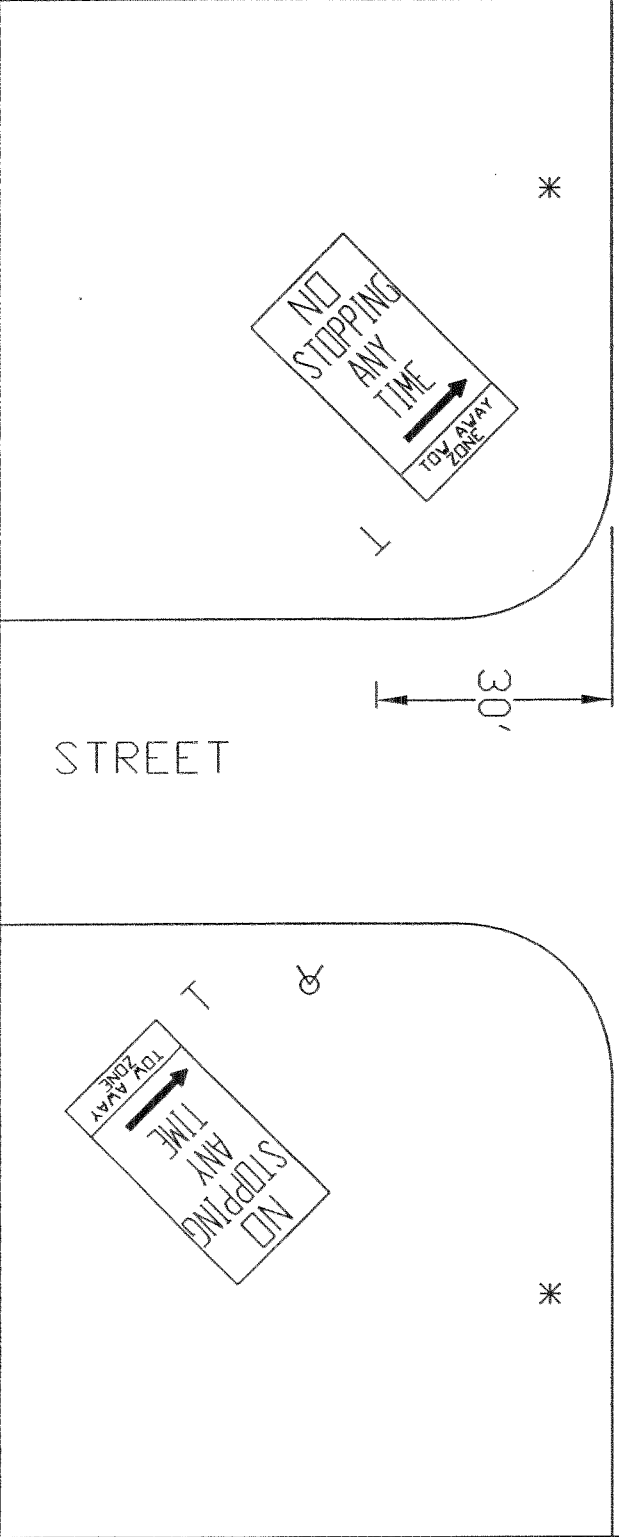

CALC. BY:
MAD
CHECKED BY:
ASB

SIGNAGE STANDARDS FOR PRIVATE STREETS

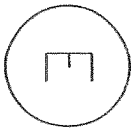

* ALLEYS WILL NOT BE POSTED
UNLESS REQUESTED BY CITY OR HOA

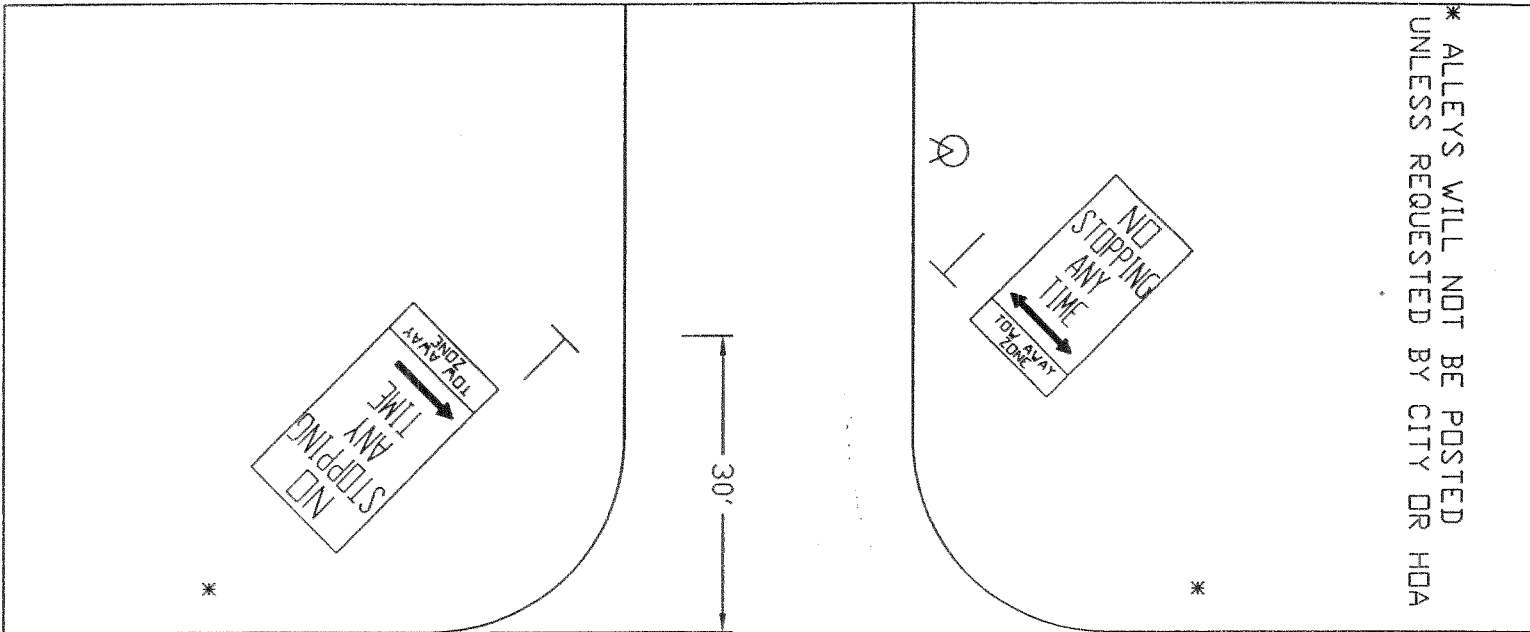

ALLEY

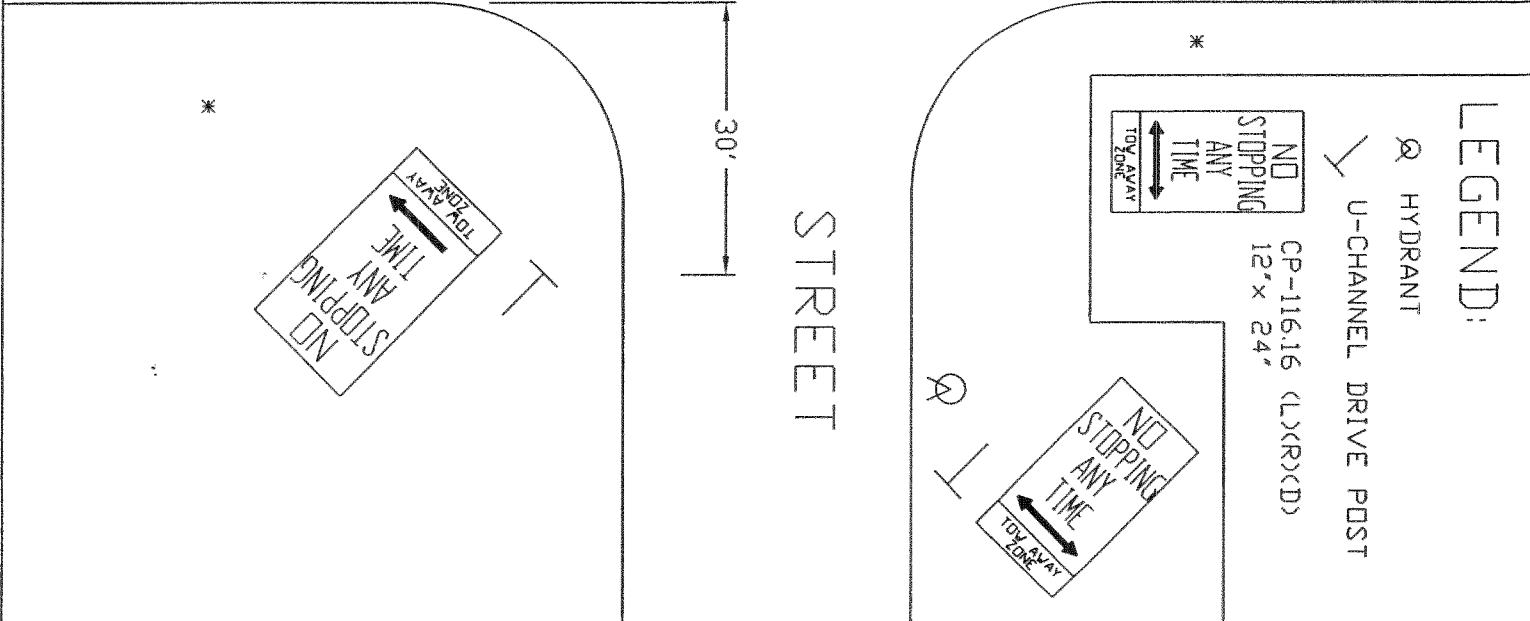

LEGEND:

⊗ HYDRANT

∟ U-CHANNEL DRIVE POST

CP-116.16 (L)(R)(D)
12' x 24"

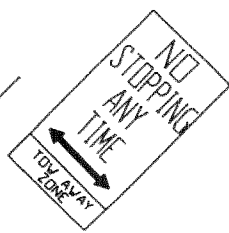
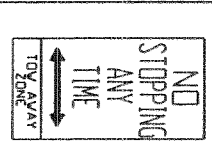

SIGNAGE STANDARDS FOR PRIVATE STREETS

CALC. BY:
MAD

CHECKED BY:
ASB

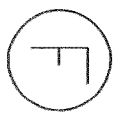

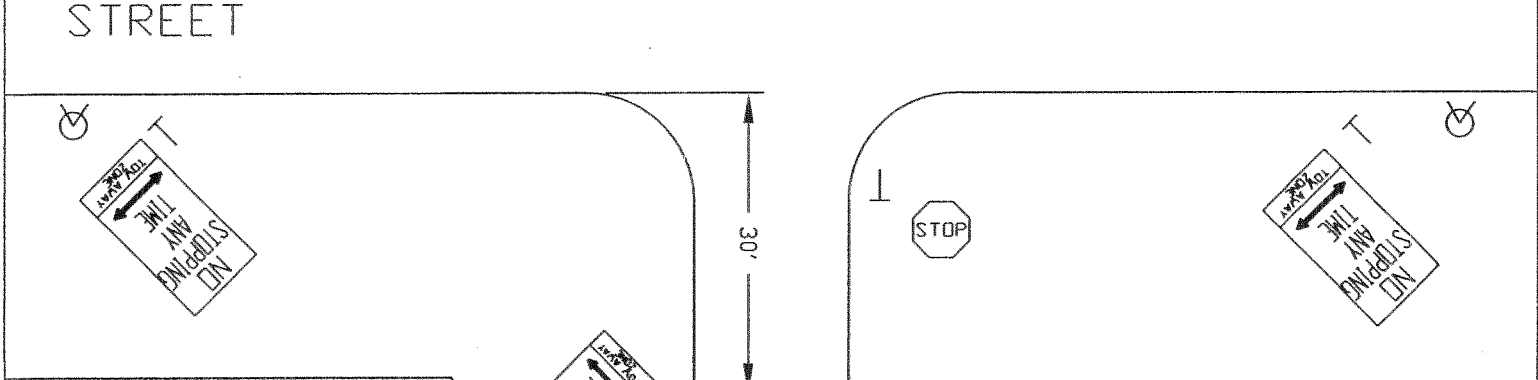
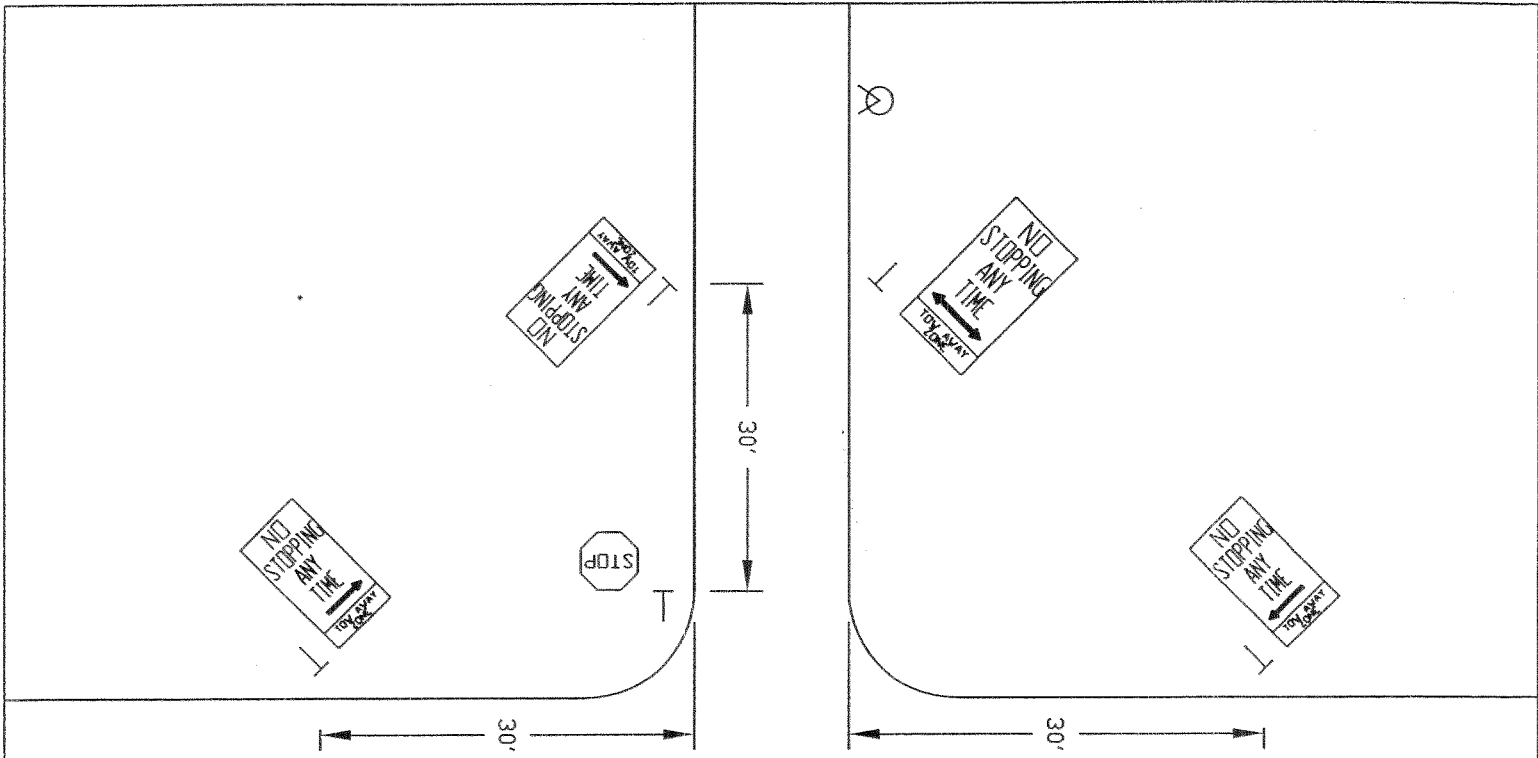

LEGEND:

- HYDRANT
- U-CHANNEL DRIVE POST

CP-116.16 (L)(R)(D)
12' x 24'

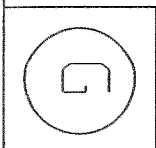

SIGNAGE STANDARDS FOR PRIVATE STREETS

CALC. BY:
MAD
CHECKED BY:
ASB

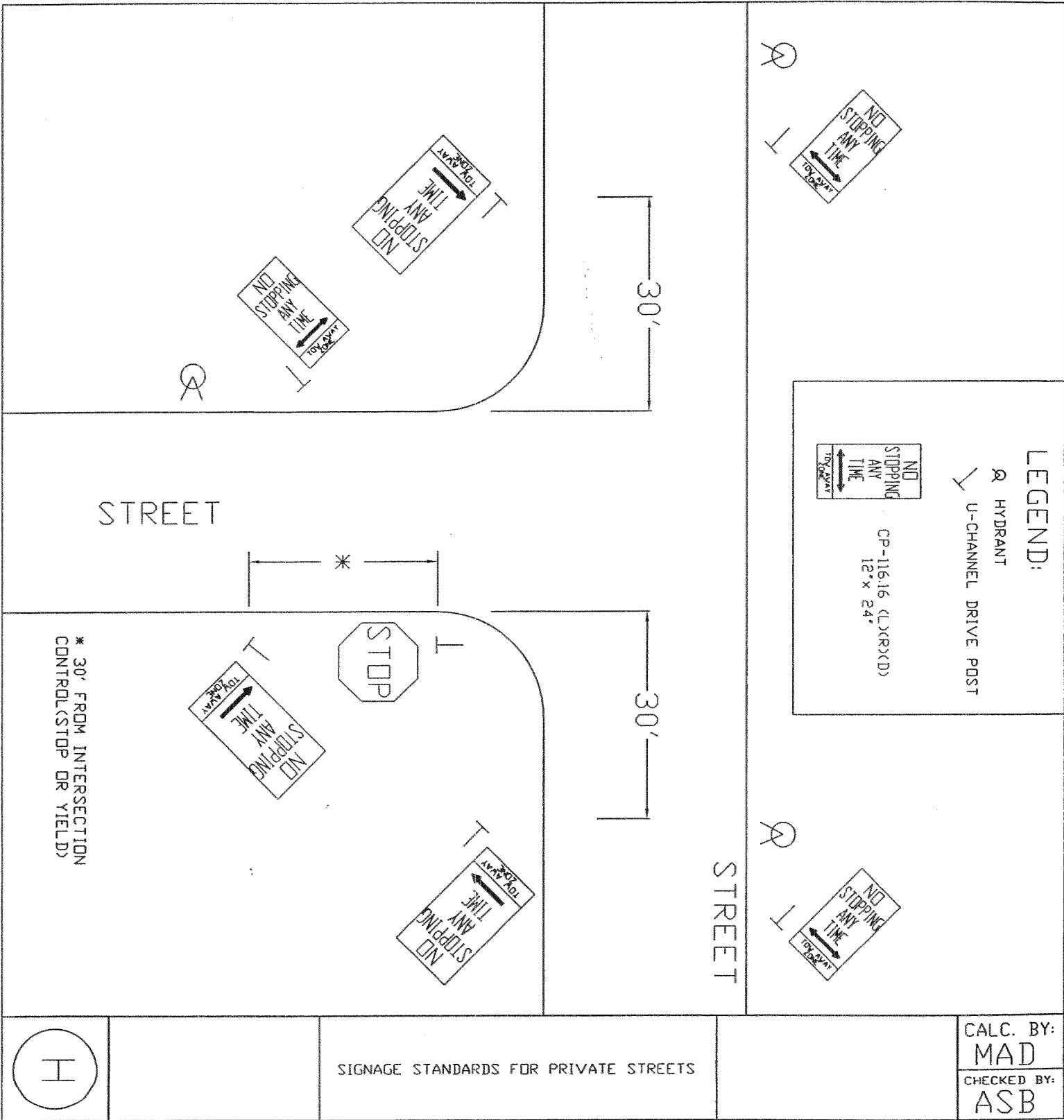

STREET

STREET

* 30' FROM INTERSECTION CONTROL (STOP OR YIELD)

LEGEND:

- ⊗ HYDRANT
- ↙ U-CHANNEL DRIVE POST

CP-116.16 (LYR)(D)
12" x 24"

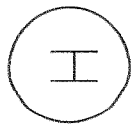

SIGNAGE STANDARDS FOR PRIVATE STREETS

CALC. BY:
MAD
CHECKED BY:
ASB

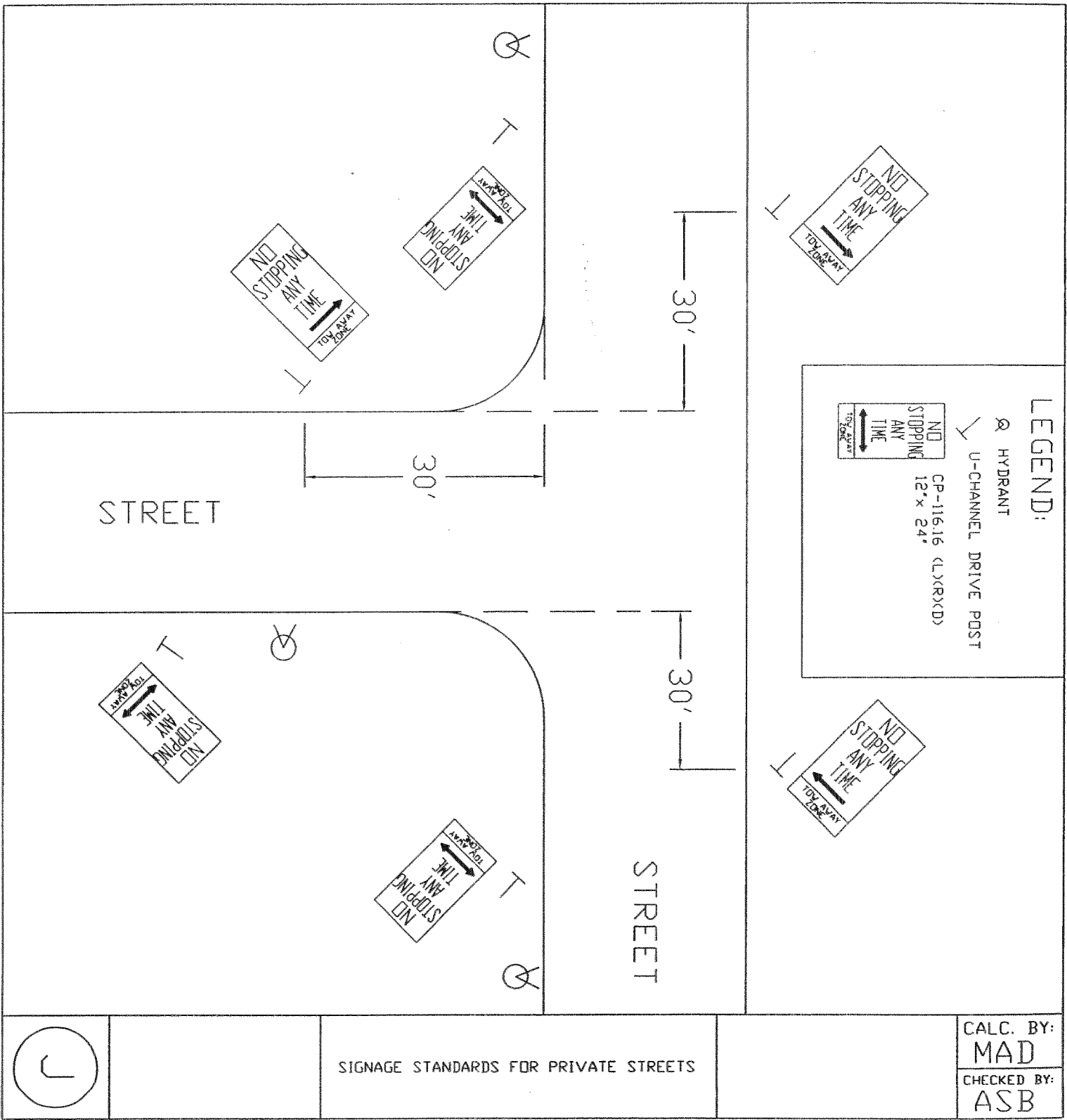

LEGEND:

- ⊗ HYDRANT
- ✓ U-CHANNEL DRIVE POST



CP-11616 (L)(R)(XD)
12" x 24"

SIGNAGE STANDARDS FOR PRIVATE STREETS

CALC. BY:
MAD
CHECKED BY:
ASB



ARTERIAL STREET



ENTRANCE STREET TO DEVELOPMENT

LEGEND:

- ⊕ HYDRANT
- ↘ U-CHANNEL DRIVE POST

ALLEY PARKING PROHIBITED VIOLATORS WILL BE TOWED	CR-430 12"x18" 18"x24" * 24"x30" *
--	---



ALLEY PARKING PROHIBITED VIOLATORS WILL BE TOWED
--

12" x 18" *

* 24"x30" or 18"x24" SIGN MAY BE USED AT THE DISCRETION OF THE DEVELOPER/HDA

FIRST CROSS STREET OR ALLEY

SIGNAGE STANDARDS FOR PRIVATE STREETS

CALC. BY :
MAD

CHECKED BY:
ASB



OPTIONAL PARKING
RESTRICTION
SIGNING FOR
ALLEYS

ALLEY

+ - 30'

STREET (OR ALLEY)

LEGEND:

⊗ HYDRANT

✓ U-CHANNEL DRIVE POST

ALLEY PARKING PROHIBITED VIOLATORS	CR-430 12'x18'
ALLEY PARKING PROHIBITED VIOLATORS	18'x24' *
ALLEY PARKING PROHIBITED VIOLATORS	24'x30' *

ALLEY PARKING PROHIBITED VIOLATORS	CR-430 12'x18'
ALLEY PARKING PROHIBITED VIOLATORS	18'x24' *
ALLEY PARKING PROHIBITED VIOLATORS	24'x30' *

* 24'x30' or 18'x24' SIGN MAY BE USED AT THE
DISCRETION OF THE DEVELOPER/HDA

CALC. BY :
MAD
CHECKED BY:
ASB

SIGNAGE STANDARDS FOR PRIVATE STREETS



ARTERIAL STREET AT ARTERIAL STREET SIGN PLACEMENT

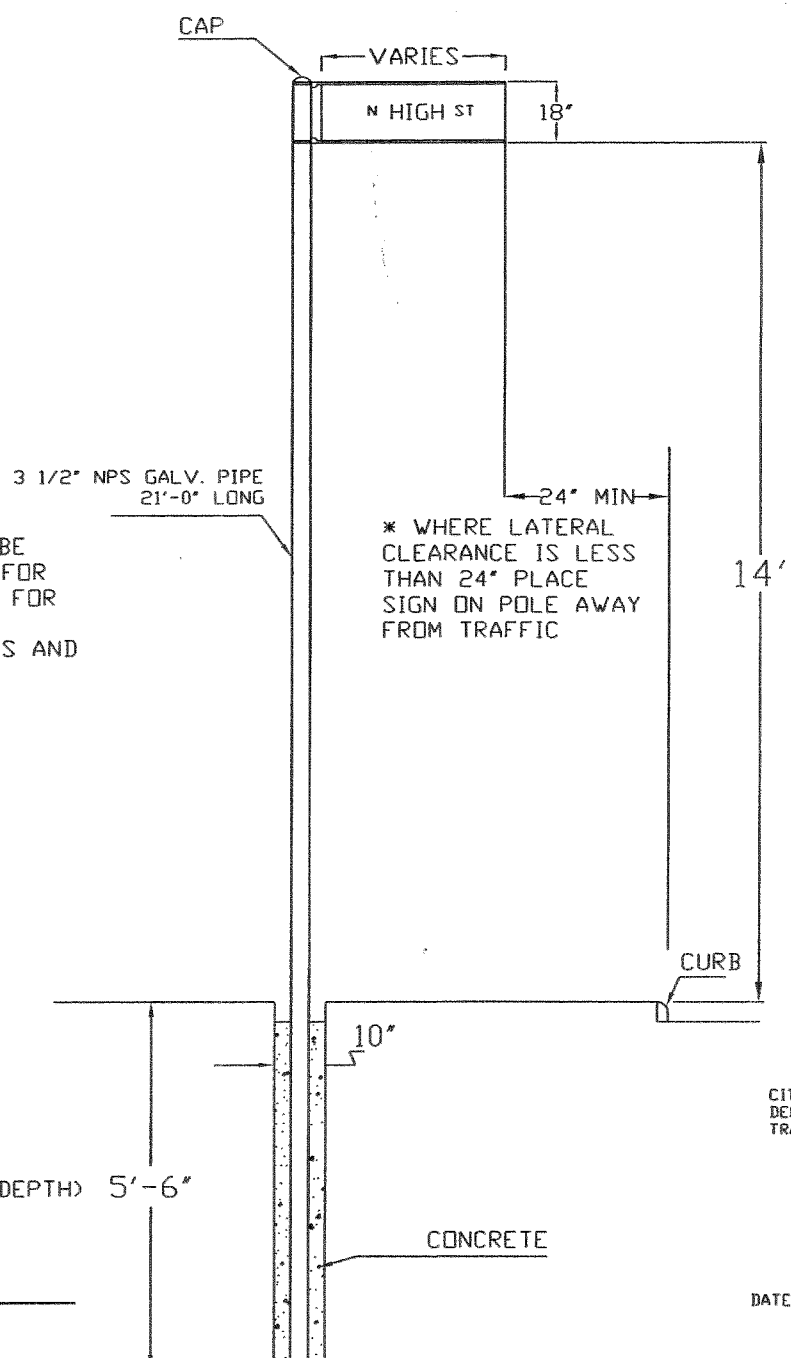

NOTE: DIMENSIONS SHOWN SHALL BE CONSIDERED MINIMUM DIMENSIONS FOR NEW INSTALLATIONS AS WELL AS FOR INSTALLATIONS USING EXISTING SUPPORTS SUCH AS UTILITY POLES AND TRAFFIC SIGNAL POLES

3 1/2" NPS GALV. PIPE
21'-0" LONG

* WHERE LATERAL CLEARANCE IS LESS THAN 24" PLACE SIGN ON POLE AWAY FROM TRAFFIC

(48" MIN. DEPTH) 5'-6"

CONCRETE

CITY OF COLUMBUS, OHIO
DEPARTMENT OF PUBLIC SERVICE
TRANSPORTATION DIVISION

APPROVED: _____
DESIGN AND PLAN SERVICES ENGINEER

DATE: _____

ARTERIAL STREET AT LOCAL & COLLECTOR STREET AT LOCAL SIGN PLACEMENT

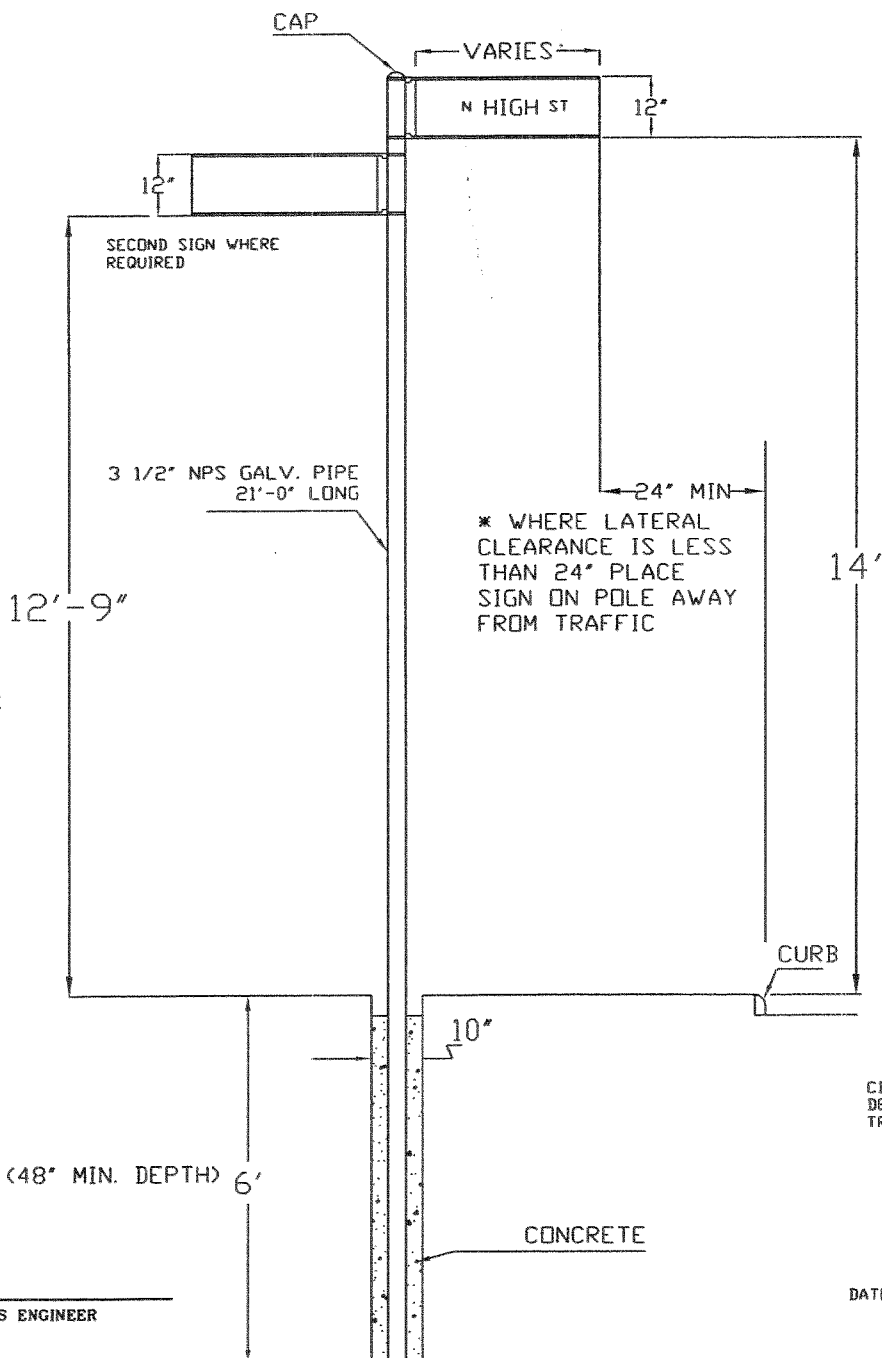

NOTE: THE MAXIMUM ALLOWABLE SIGN AREA IS 10SQ. FT. IF AREA IS GREATER, USE ONE POST FOR EACH SIGN.

CITY OF COLUMBUS, OHIO
DEPARTMENT OF PUBLIC SERVICE
TRANSPORTATION DIVISION

APPROVED: _____
DESIGN AND PLAN SERVICES ENGINEER

DATE: _____

LOCAL STREET AT LOCAL STREET SIGN PLACEMENT

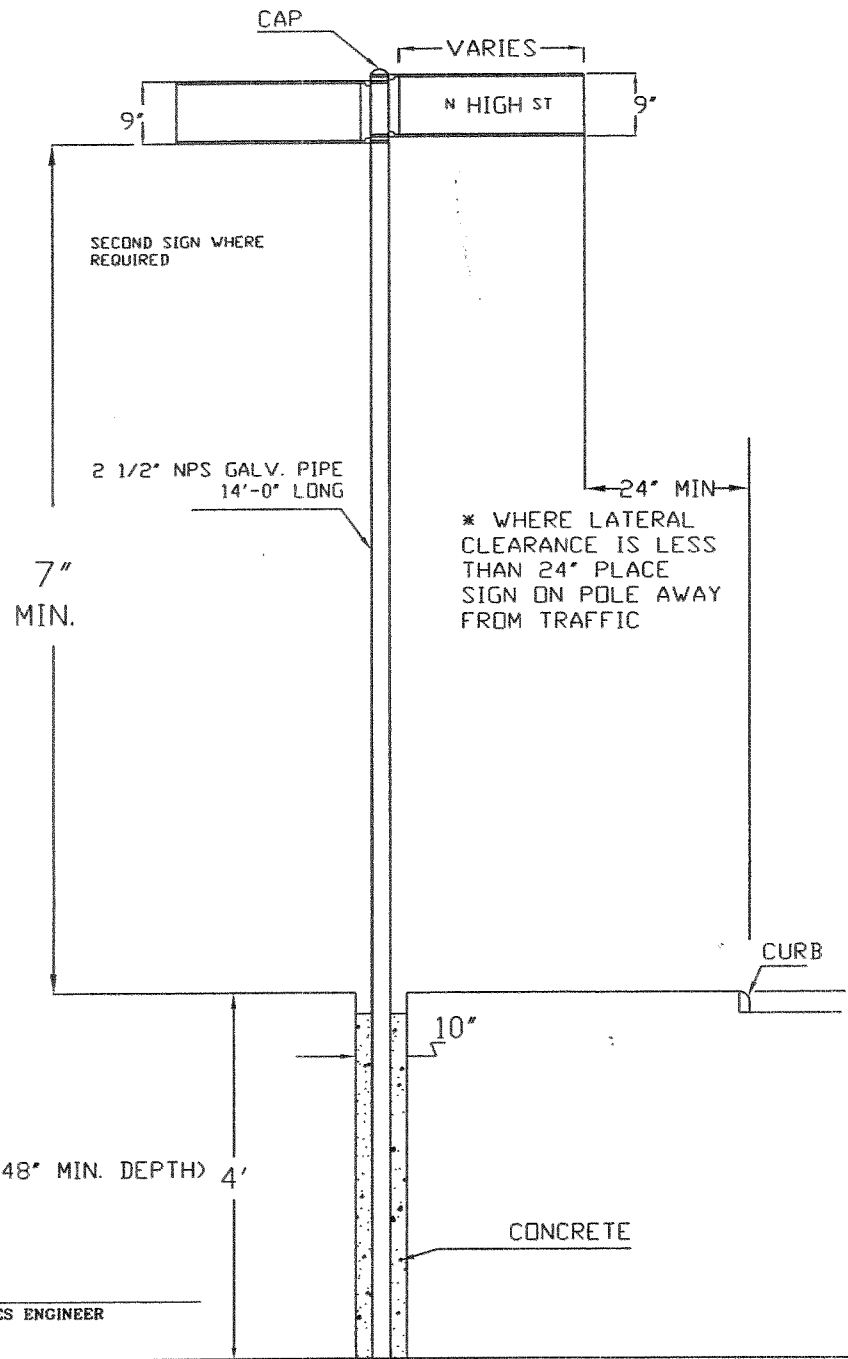

CITY OF COLUMBUS, OHIO
DEPARTMENT OF PUBLIC SERVICE
TRANSPORTATION DIVISION

APPROVED: _____
DESIGN AND PLAN SERVICES ENGINEER

DATE: _____

STREET NAME INSTALLATION STANDARDS

ARTERIAL AT ARTERIAL

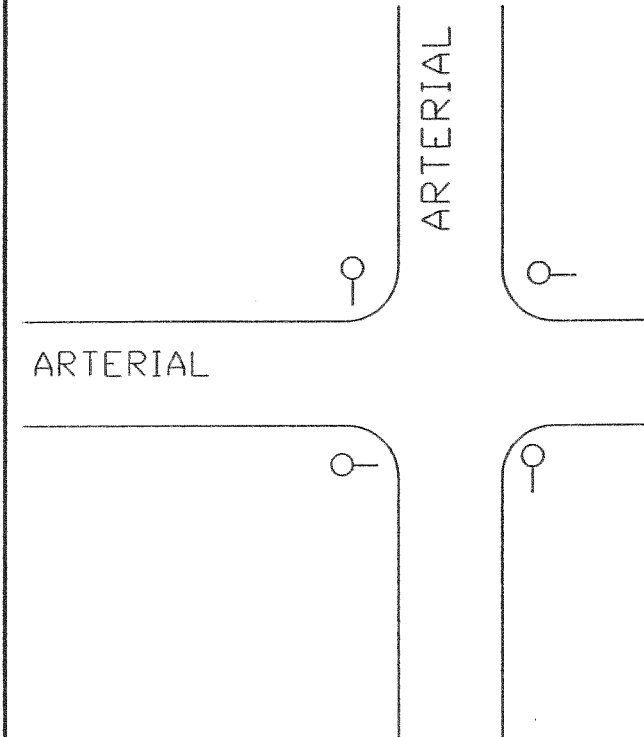

ALL SIGNS SHALL BE 18"
HIGH X REQUIRED LENGTH,
MOUNTED 14' ABOVE
GROUND LEVEL.
SIGNS SHALL BE LOCATED
NEAR LEFT AND FAR
RIGHT AT ALL LOCATIONS.

IF INTERSECTION IS SIGNALIZED
SIGNS CAN AND SHOULD BE MOUNTED
ON SIGNAL POLES WHENEVER
POSSIBLE

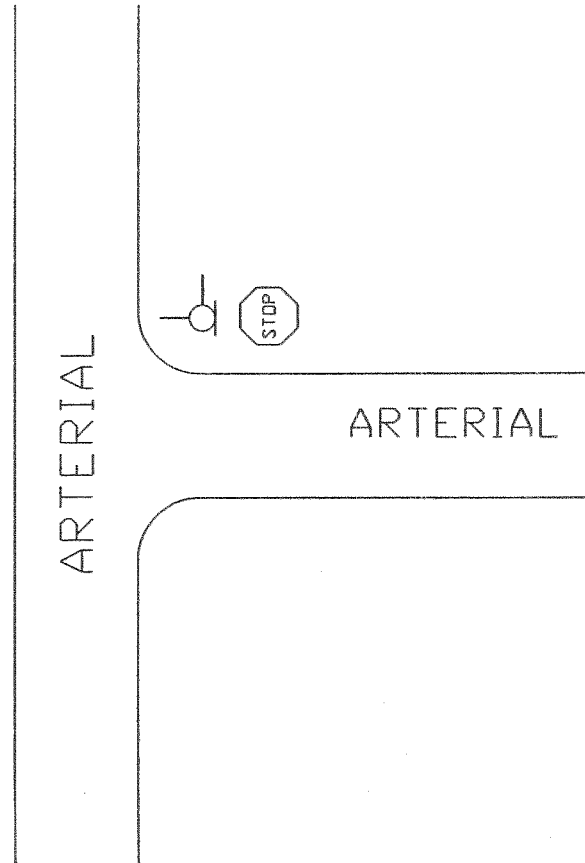
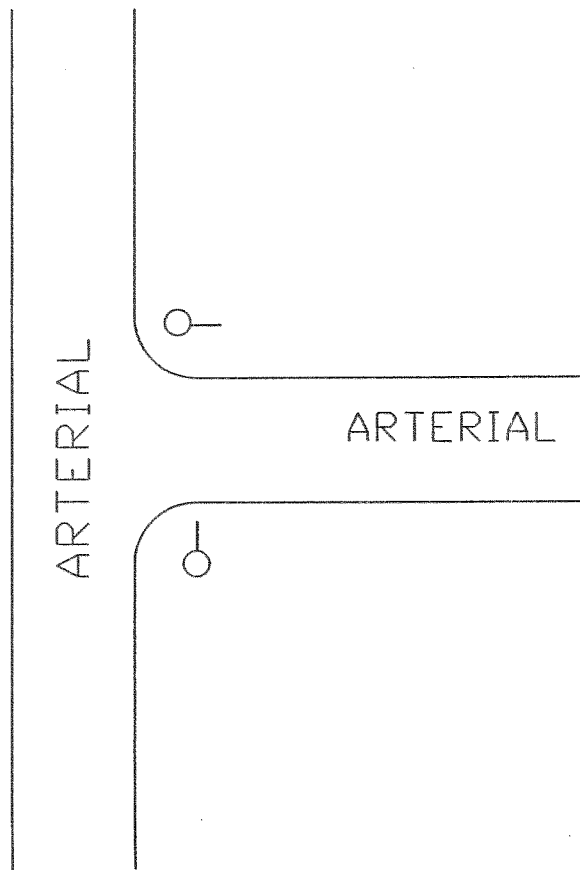

APPROVED: _____
DESIGN AND PLAN SERVICES ENGINEER

DATE: _____

STREET NAME INSTALLATION STANDARDS

ARTERIAL AT LOCAL & COLLECTOR AT LOCAL

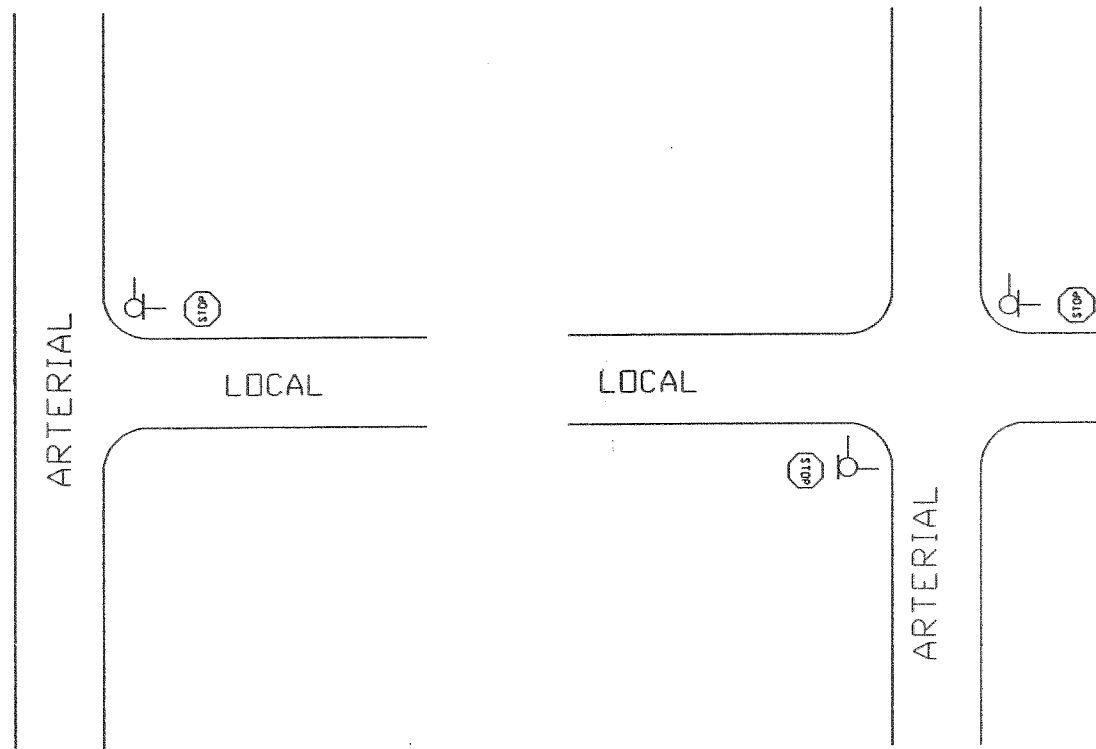

ALL SIGNS SHALL BE 12" HIGH x REQUIRED LENGTH, MOUNTED 14' ABOVE GROUND. SIGNS SHALL BE LOCATED FAR RIGHT FOR THE ARTERIAL WITH TWO SIGNS PER POST. IF THE COMBINED SQUARE FOOTAGE OF THE TWO SIGNS EXCEEDS 10 SQ. FT. USE SEPERATE POST FOR EACH SIGN AS ABOVE.

STREET NAME INSTALLATION STANDARDS

LOCAL AT LOCAL

ALL SIGNS SHALL BE 9" HIGH x REQUIRED LENGTH, MOUNTED 10' ABOVE GROUND LEVEL. LOCAL COLLECTOR OR RESIDENTIAL STREETS SHALL BE SIGNED WITH TWO SIGNS PER POST, LOCATED IN SUCH A MANNER AS TO MINIMIZE OBSTRUCTION OF OTHER TRAFFIC CONTROL SIGNS. SIGNS SHOULD BE COMBINED WITH STOP OR YIELD SIGNS WHENEVER POSSIBLE.

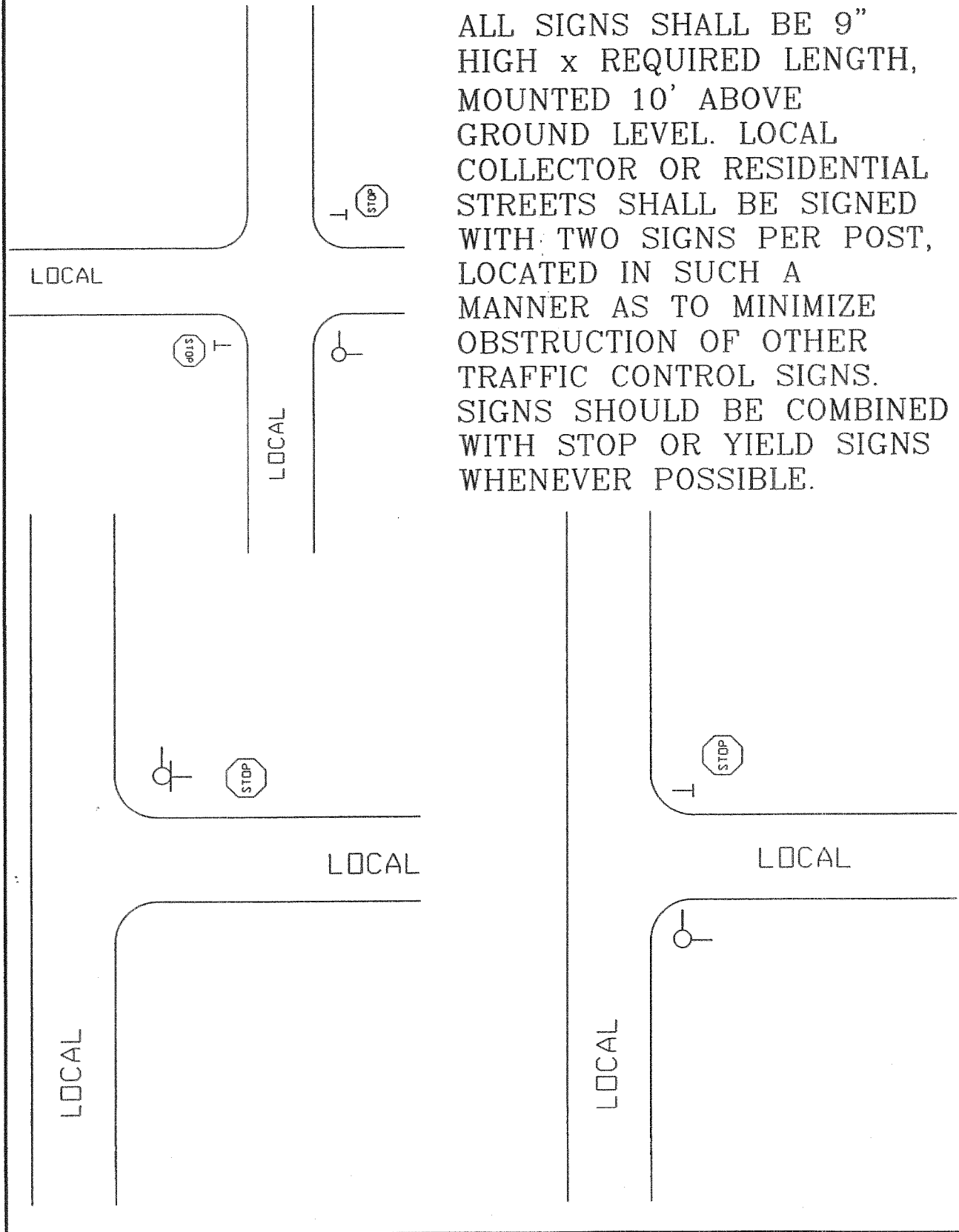

APPROVED: _____
DESIGN AND PLAN SERVICES ENGINEER

DATE: _____

MOUNTING HARDWARE DETAILS

FASTEN TO SUPPORT WITH PRE-ASSEMBLED
BUCKLE-STRAP COMBINATION ASSEMBLY

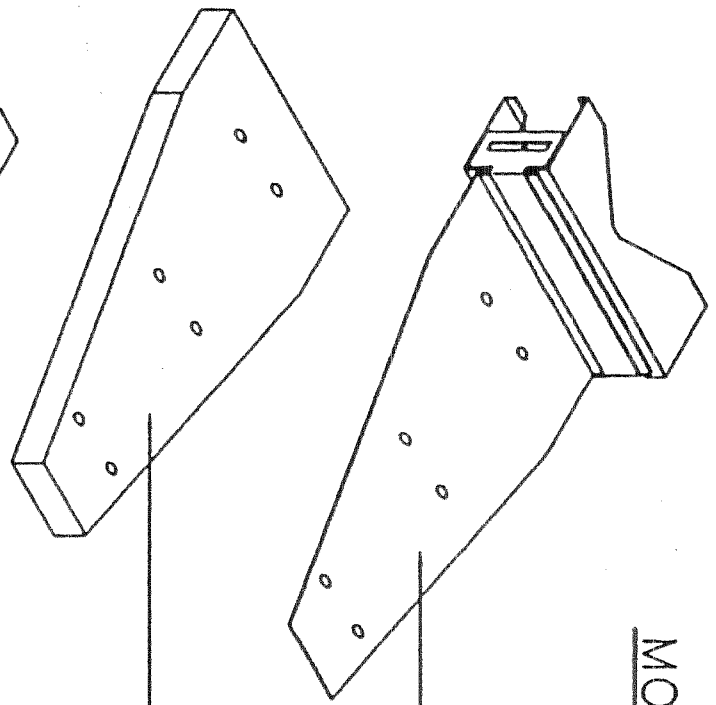

ADDITIONAL CANTILEVERED BRACKET •

SPACER •

UNIVERSAL CHANNEL CLAMP

UNIVERSAL CHANNEL CLAMP SLOT BAR

• USED WHEN SIGN AREA EXCEEDS
SIX (6) SQ. FT.

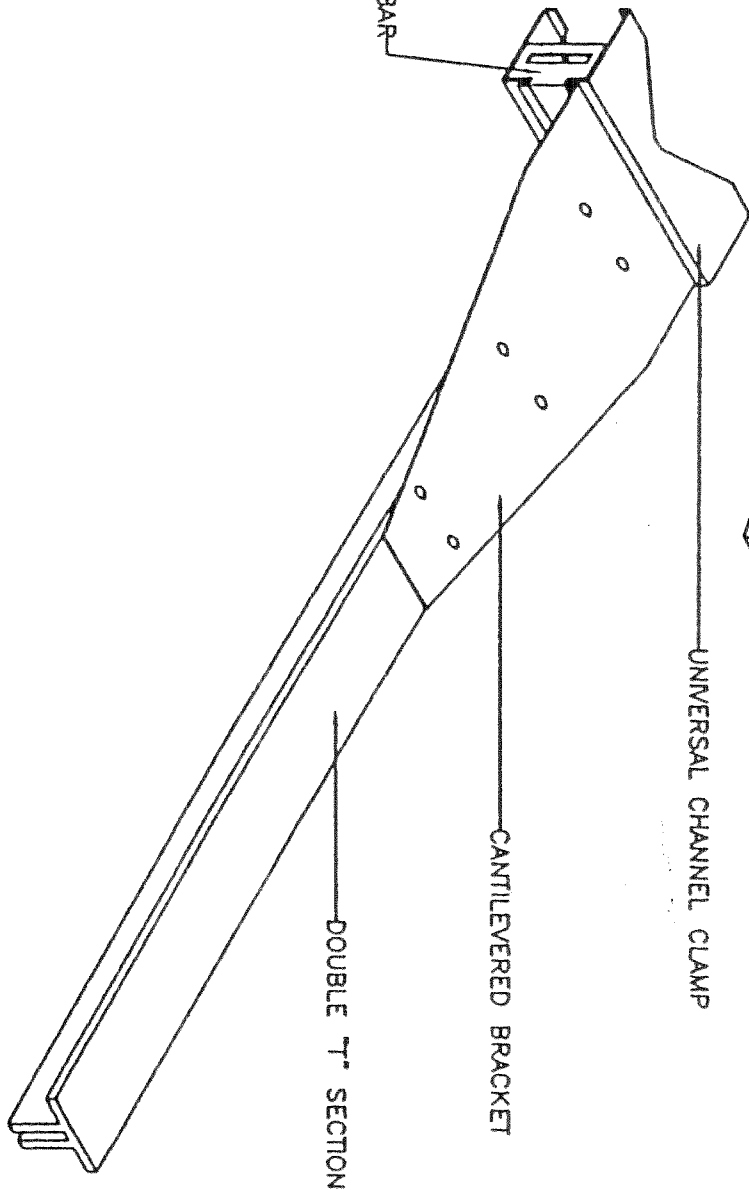

CANTILEVERED BRACKET

DOUBLE T" SECTION